

CONCEPT: COMMUNITY

Hammersley Architecture was asked to create a feasibility study for renovating an existing performing arts theatre in Oak Park, IL. The facility suffered from years of deferred maintenance and a previous remodeling that left the existing spaces cluttered. Further, the needs of both the acting community and local theatre patrons had shifted. Small theatre companies now are mobile and book short runs at rotating venues. The local patron community wanted a more vibrant and useful space.

We proposed a new model of operation for this playhouse, focusing on three major components- community access, theatre space, and actor / crew access. We clarified and expanded the programs of both the public and actor / crew areas, and wrapped the theatres with this updated program. We surrounded the the performance spaces with the things that make it thrive- those who appreciate it, and those who create it.



NEW COMMUNITY SPACES

Our proposal included creating multi-use spaces for the surrounding patron community and adding more programming.

Architecturally, we proposed creating a new continuous front lobby space that was visually and physically accessible to the community passing by. The expanded lobby would allow for diverse and expanded programming for the space at different times of the day and year- dancing classes in the morning, private art gallery reception in the evening. The intent was to bring the local community to the place at times other than just in the evening for a performance.

We envisioned a lively, bustling front lobby buzzing with all different kinds of activity- a space that inspires and connects like minded appreciators of the arts with a facility designed to facilitate interaction and exchange.

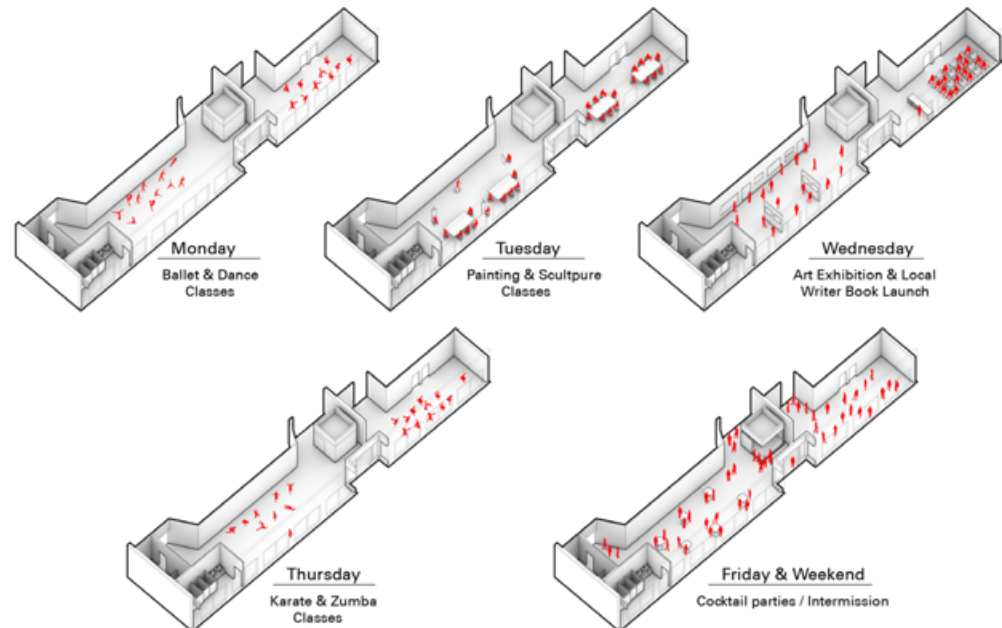
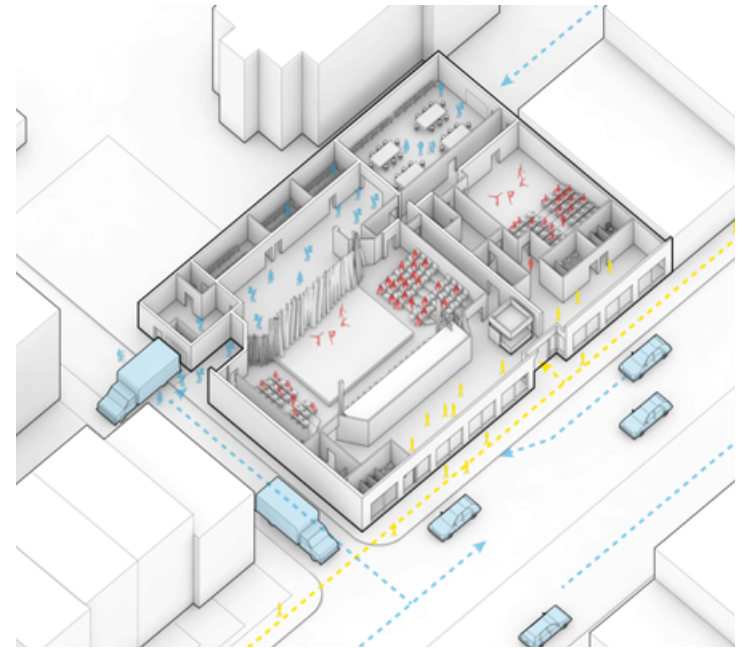
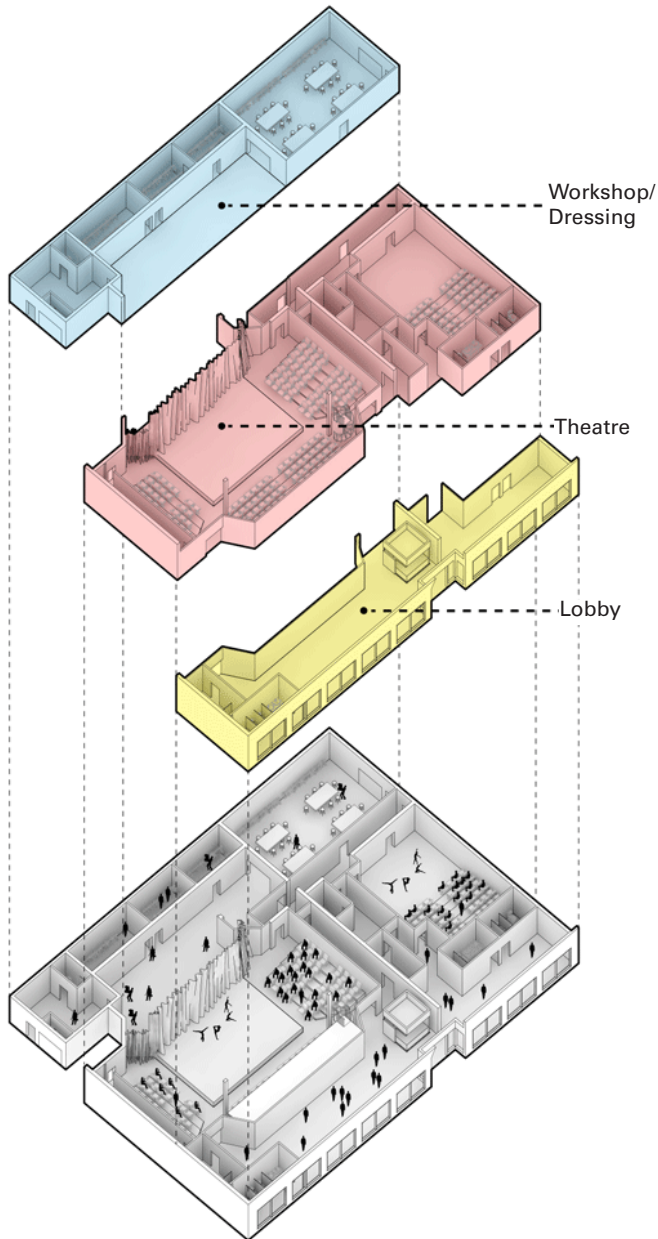



COMMUNITY UNDER ONE ROOF

A continuous wood-clad floating ceiling runs the length of the entire building, connecting both sides visually, physically, and materially. Skylights and lighting flow along the ceiling's path, bringing different types of light into the space at different times of the day. This new space allows for a multitude of activities, and serves to create a haven for many types of artistic expression and patronage.

